

SeiyaX Smart Talkie



User Manual

An amazing voice input and translation device

Key Description

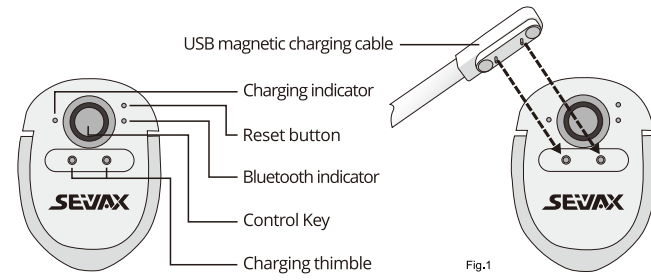

Control key

Press and hold it > Speak > Release > Finish translation. Maximum record time is 1 minute.

Charging thimble

Apply the magnetic charging cable (Fig.1) on the charging thimbles. The charging indicator will be light on when it is fully engaged.

Charging indicator

Red light = Charging, Green light = Full charged.

Reset key

Reset the device if it stops working occasionally. Insert a needle into the reset hole and click the Inside button to reset the device.

Bluetooth indicator

Click the control key to turn on the bluetooth, the blue light will be twinkling for searching adjacent devices.



Note: Browse this link or Scan the QR code for video instruction <https://www.seiyax.com/key-description>

Setup and Installation

Search app install

Search, download, and install the "Smart Talkie" App from the Google Market or Apple Store.

You can also scan the QR code below accordingly



For Android OS

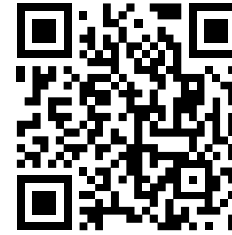

For Apple IOS

Pair the Bluetooth

- 1 Turn on the bluetooth of your smart phone.
- 2 Click on the Control Key on Smart Talkie, the blue light will be twinkling.
- 3 You will see "smart voice" on your smart phone, then click it to start pairing. Finally you will see the connected status under "smart voice".

Note1:

the blue light will not twinkle when the Smart Talkie has connected with a smart phone or has no power. Please do not keep on clicking the control key and think the device is broken.

Note2:

The Smart Talkie will cut off bluetooth connection if you do not use it in 10 minutes. You can re-connect it by click on the control key again.

Application

1.Set the languages on Smart Talkie App

Open the Smart Talkie App installed on the phone (Fig.1.1 Android example and Fig.1.2 iOS example), select and set the original language by clicking the left button (e.g. "Chinese" in the Fig.1.2), and click the right button (e.g. "English (USA)" in the Fig.1.2) to set the target language for translation. Then the translation will be from Chinese to English.

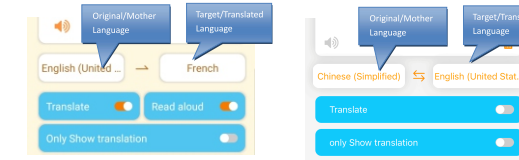

Fig.1.1(Android example)

Fig.1.2(iOS example)

2.APP switches introduction

- 2.1 Translate. If you only use voice input, no need to turn on "Translate" switch. The Smart Talkie will convert your speech to text. If you want to translate your speech to another language, you need to turn on this switch.
- 2.2 Read aloud. If you turn on the switch, you can hear the translated results in speech.
- 2.3 Only show translation. You only can see this switch when you turn on the "Translate" switch. If you turn on this switch, you will only see the translation. If you turn it off, you can see both your original input and translation on your smart phone See(Fig.2.1).

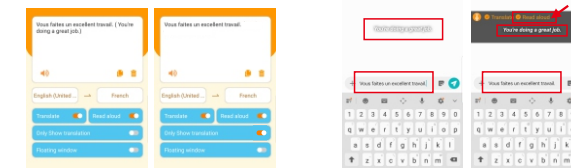

Fig.2.1

Fig.2.2

Fig.2.3

2.4 Floating Window. This switch is only active when "Only show translation" switch is on. It can show your original input on the floating window and show the translated text on your apps, which enable you to make sure the original language input is correct on the floating window.



Android version

Note:

This switch is only working on Android smart phone but not on iOS due to the bluetooth authorizations. For Android version, the original language text result will be shown on the floating area as Fig.2.2 and Fig.2.3. When you touch the floating window in Fig.2.2, it will show as Fig.2.3 You can check the original input text before sending the translated text out.

2.5 For device OS version is higher than iOS 14.5.1

This switch is only for device which iOS is higher than 14.5.1. Because iOS 14.5.1 disables the copy and paste functions, we have to switch on the "Show picture-in-picture" switch, so that we can use Smart talkie voice input in any apps. If this switch is off, the input will stop working. You can slide and hide the picture-in-picture as show on the pictures. See Fig.2.4, Fig.2.5 and Fig.2.6

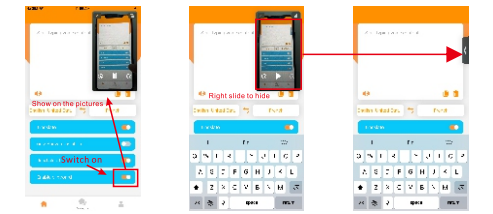

Fig.2.4

Fig.2.5

Fig.2.6

Application

3.How to use voice translation

After you finish above settings in Smart Talkie APP, you can use the voice input or translation function in any third party APPs, such as SMS, Whatsapp, WeChat, Instagram, Skype, Facebook, Line, email, Wechat, QQ and so on. Put the cursor on your APP to start input. Press and hold the Control Key of Smart Talkie. Start to talk and release the Control Key after speech. The results will show on the smart phone.

Note: The maximum recording time is 1 minute.

4. How to use Text Translation

Click to select the source language and target language (Fig.3.0), enter or paste the text to be translated in the input box, and click the translate button to translate the text to the target language. This function allows you to search the meaning of the unknown vocabulary or translate the whole page of article you copied from the website or documents.

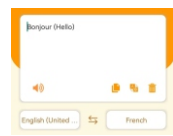

Fig.3.0

5. Voice Translation Broadcast

1. Click on this option to activate the voice broadcast. Click the repeat icon to repeat the voice broadcast.

2. Click on this option to activate the floating window mode, then you can use the broadcast function on other APPs. Double click the target language on the floating window will broadcast the voice translation after a delay of 2 seconds, so that you can perform voice recording when you are using whatsapp or any other voice



After you are familiar with the operation, you will be able to send translated voices on your apps. Scan the QR code to view the video tutorial.

6. How to use Face to Face voice translation.

- 4.1 Click on "Translate" option which is at the bottom of the Smart Talkie App (See Fig. 3.1 for Android version) Click "Dialogue" (See Fig.3.2 for iOS version).

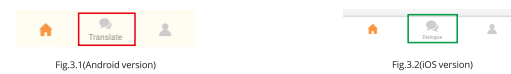

Fig.3.1(Android version)

Fig.3.2(iOS version)

- 4.2 Set the original language and target language by clicking the languages buttons. See example of "Chinese (simplified)" and "English(United States)" in Fig.3.3 Then you will see language option list. You can slide the language list to choose the one you want.

- 4.3 Hold the virtual speech button or to start speaking. For Chinese to English. (See Fig. 6) Press and hold the to speak Chinese. Release the button after you finish talking. The App will show both Chinese and English translated results on the same page. For English to Chinese Press and hold to speak English. The rest steps are same as above.



Fig.3.3

- 4.4 You can click on this icon to delete all records on the screen. Or click and hold your finger on the screen to pop up the edit window, where you can select to delete particular contents.

- 4.5 You can click this icon in the upper left corner to save the history and share it as a TXT file. This function is convenient for those of who need to keep records for language study or meeting note.

7. Text translation function.

You can use the function when you see some text in foreign language which you do not understand when you are browsing the web pages or in chatting apps.

- Set the target language on your left and your original language on the right (see Fig.3.4)
- Turn on the "Translate" switch.
- Copy the text which you want to be translate from your Whatsapp or any social media apps.
- Return the Smart Talkie APP, then the translated results will be displayed immediately.



Fig.3.4

Note1:

e.g., if you want to translate German text into English, you need to put English on the left and German on right. Not the same as voice input.

Note2:

translation length is 500 characters. So if your text is more than 500 characters, you need to copy less than 500 characters at a time.



Note: Browse this link or Scan the QR code for video instruction <https://www.seiyax.com/application>

User Tips and Trouble Shooting

The Smart Talkie device can't pair Bluetooth with the smart phone.

- Click the control key to see whether the blue light is twinkling. If not, please charge it to check whether the charging light is on.
- If the charging is ok, please check whether you have connected the Smart Talkie device with another smart phone already.
- You need to disconnect the Bluetooth with previous smart phone, or turn off previous smart phone's Bluetooth, then you can start to pair the Smart Talkie device with new smart phone.
- The Smart Talkie hardware is BLE 4.0. For phones which do not support BLE but Bluetooth only will not find the Smart Talkie device.

Recognize accuracy is not good.

- Below tips can help your smart talkie recognize your speech more accurate.
- Not speaking in a too noisy place.
 - Hold the control key, wait 1s, then start to speak. After you finish speaking, wait 1s again, then release the control key button. The correct operation will help Smart Talkie collect your speech completely.
 - It's better to talk within 30s for each time to have higher accuracy.

Slow response or no recognition / translation results come out

- Please check your mobile phone network because poor network will affect the response speed.
- Due to the software compatibility problem between Smart Talkie APP and other 3rd party input APPs, some phones may not recognize/translate text after speaking. Some input method may not function as stable. The solution is to change the default input method to built-in text input or other input methods.
- Normally the translation result will come out automatically, but if it does not come out, it may be saved on your clip board. So you just need to use your finger to hold on the text area and paste the translated result out from it.
- Smart Talkie App only works with iOS 9.0 or above, and Android 4.4 or above. And it only works well in smart phones. It may also work with iPad or Android tablet PC, but smart talkies are not fine tune to match different screen size and other more technical reasons, so we cannot guarantee.
- The voice input for typing only works when the Smart Talkie app is running on the phone. So if you have to do a lot of text message and translation, please make sure the app is still running on the background of your device.

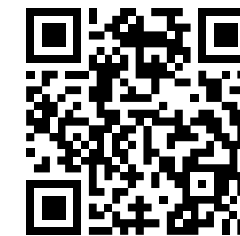

Note: Browse this link or Scan the QR code for video instruction <https://www.seiyax.com/trouble-shooting>

How to attach Smart Talkie to your phone?

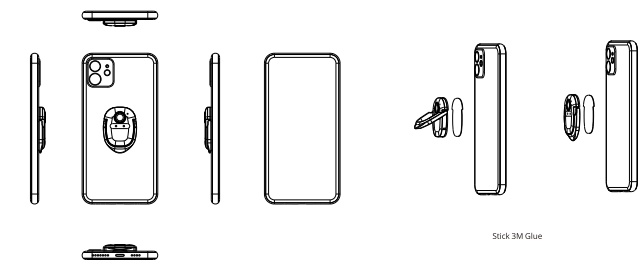

Stick 3M Glue

Specification

Bluetooth version: BLE 4.0 Battery capacity: 70mAh Charging time: around 2hrs
Standby time: 20 days
Dimension: 46*31.5*4.3 MM
Net weight of product: 15.59 g



For more product information, latest software update, video guidelines and variety of skills to make a good use of SeiyaX Smart Talkie, please visit our official website at www.seiyax.com or scan this QR code or contact us by email at SeiyaX@yeah.net. Thanks again for choosing SeiyaX product!